

BEFORE YOU BEGIN

- Read installation guide in illustration and word file carefully, and install the tank according to instructions in the guide to avoid product damage and installation inconvenience caused by inappropriate operation.
- All data contained is based upon the last product information available at the time of publication. Kohler Company reserves the right to implement changes of product characteristics, packaging and availability at any time without further notice.
- Do not apply erosive cleanser and solvent in the tank, which will damage tank spares and result in leakage in the tank. Kohler will not be responsible for any damage related to above mentioned cleanser or solvent.
- Do not apply spares that are not provided by Kohler, and please note that glass adhesive tape shall not be applied to the installation of Kohler spares. Kohler will not be responsible for any damage related to installation with spares not provided by Kohler.

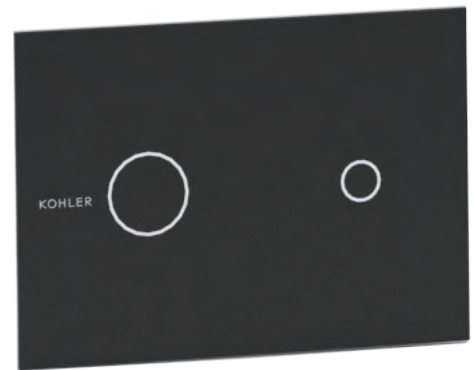

PRODUCT SPECIFICATIONS AND FUCTION SETUP

Region	China/
SKU number/SKU	K-24147T-7
Rated voltage/ Rated operational voltage/	220V-240V~, 50/60 Hz / 6V ± 10%
Maximum instantaneous power/	8W
Outer dimension of product/ (L*W)	225mm × 160mm (Length x Width)
Weight of product/	About/ 1.7 Kg
Ambient temperature of usage/	1-55 °C
Flush control board LED light color/LED	White 6000K color temperature/ 6000K
Entry induction distance/	700mm ± 50mm
Exit induction distance/	900mm ± 50mm
Entry Induction time/	2s
Exit induction time/	3~8s
Automatic full flush induction time/	≥ 60s
Automatic half flush induction time/	8~60s
Full flush wave induction time/	≥ 0.3s
Half flush wave induction time/	≥ 0.3s
Music on/off induction time/ /	≥ 2s
Cleaning mode/	Quick press L key
Music on/off/	Quick press M key
Night light switch/	Quick press R key

ROUGHING-IN

Reference Value

UNIT : mm

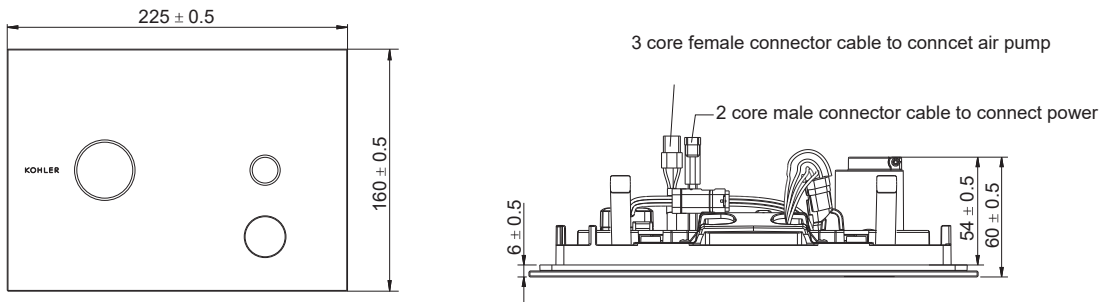

Kohler reserves the right to change marked dimensions without prior notice.

PACKAGING LIST

S/No.	Material No.	Material Description English	Unit
1	1348781	Faceplate Body	1pc
2	1348693	AC Glass Cover Assy	1pc
3	1385914-T01	Installation Instruction	1pc
4	1385914-T8	Service Parts Page	1pc
5	1385767	Fixed tube pack	1pc
6	1385768	Fixation plate pack	1pc
7	1385769	Anti-theft Screw Pack	1pc
8	1407652	Pump Control Module Assy	1pc
9	1407650	Transformer Assy 220V	1pc
10	1348733	Carton Individual	1set

A: Transformer Installation

Before the in wall tank is installed, the transformer is installed on the wall first. (It is recommended to place transformers on the ceiling or other hidden and easy to operate places.) As illustrated, the output connector of transformer (with 2 core female connector) through the bushing pipe (the bushing pipe dia. $\Phi 16 \sim \Phi 20$ is recommended) into water tank. Connect the input terminal of transformer (black) with power supply 220V AC. Customer can use the PVC pipe for wiring. See figure

 **Warning:** Don't mistake the input and output terminal, or it may cause damage to the product. Insulation measures must be taken at the connection. Otherwise, short-circuit current may occur and damage the transformer.

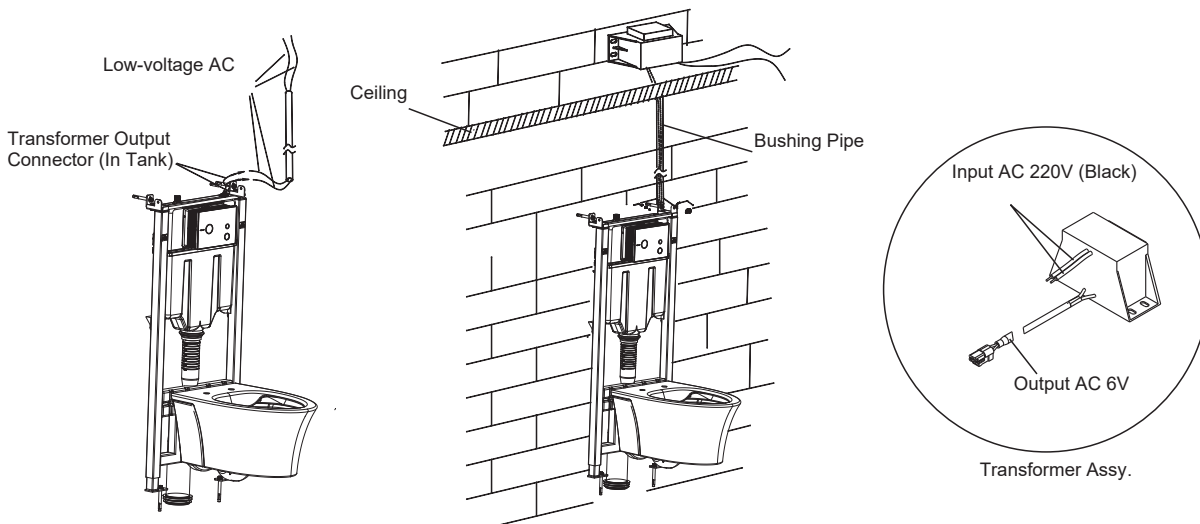

B: Faceplate Installation

1. After the transformer and the circuit are properly connected, the in wall tank is installed according to the installation instructions until the construction of the false wall in front of the water tank is completed.
2. Install pump control module assembly to faceplate body, connect emergency flush air hose to outlet pipe in air cylinder. Connect output signal cable and input signal cable together, and tighten nut. See figure

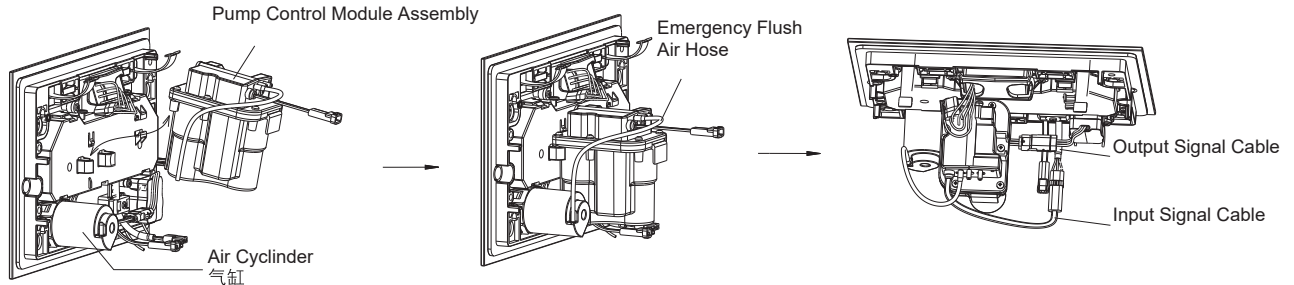

3. Connect big flush air hose and half flush hose to outlet joint in pump control module assembly. Connect power output cable of transformer and power input cable of faceplate body together, and tighten nut. See figure
 Note: Cut the excessive parts of air hose if necessary and fix it onto the tank fastener.

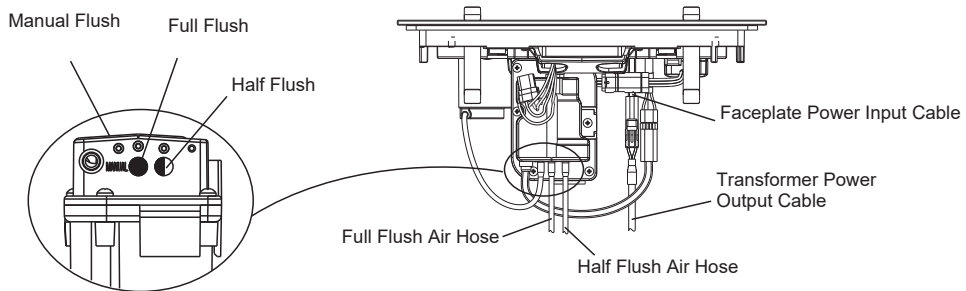

4. When tighten four locknuts on faceplate body, adjust to "OPEN" mark as shown. See figure

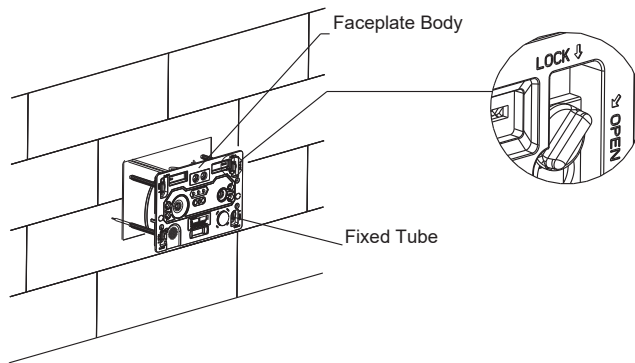

5. Tighten four fixed tubes to "LOCK" mark after installing faceplate body as shown. See figure

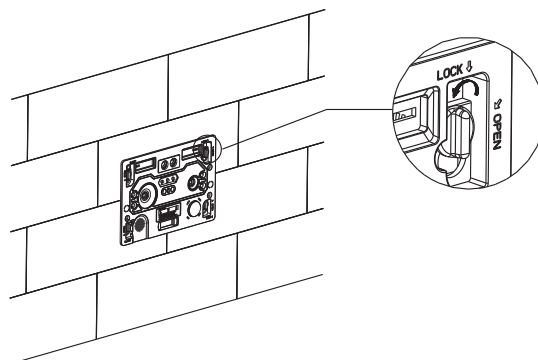

6. Fix two anti-theft screws on faceplate body with screw driver against easily taking away faceplate. See figure

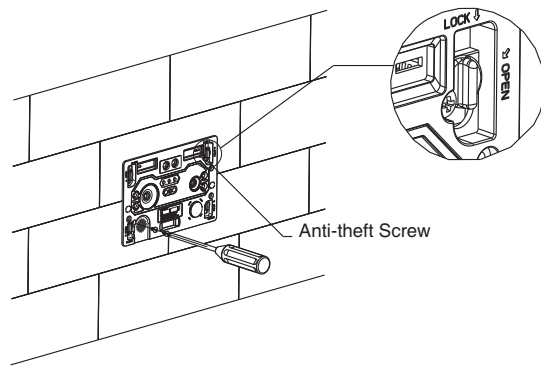

7. Assemble glass cover assembly on faceplate. Insert fixed tapes into the faceplate holes. See figure

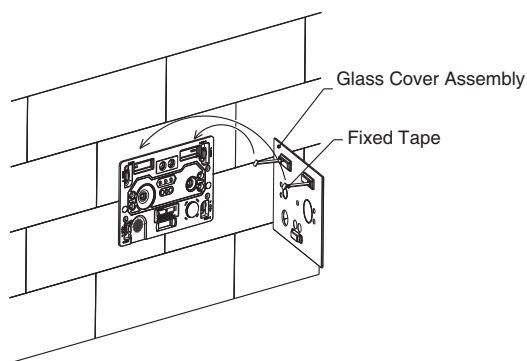

8. The installation of pinch plate, the pinch plate installation provides another method for faceplate, that is, the faceplate don't rely on the position of the in wall tank and the mask, and can directly install the faceplate to the false wall. The location of faceplate to refer the 1 meter high from the finished floor to center of faceplate is recommended. 7~20mm thickness is recommended for the wall of the pinch plate and recommended $80 \pm 3\text{mm}$ gap is reserved. Recommended the installation hole size of $201^{+2}_0 \times 136^{+2}_0 \text{mm}$. See figure

